



## 4 Beckham Place

Lower Compton, Plymouth, PL3 5EZ

**Offers Over £230,000**



A well presented end terrace townhouse in Lower Compton, Plymouth with a lovely Mediterranean style courtyard garden. The accommodation comprises lounge, modern kitchen, family bathroom with bath & shower, 4 bedrooms & the master bedroom having an en-suite. uPVC double-glazing & gas central heating.





BECKHAM PLACE, LOWER COMPTON, PLYMOUTH, PL3 5EZ

ACCOMMODATION

Entrance via a composite front door with obscured glazed panels opens up into the porch.

PORCH 3'3" x 3'1" (1 x 0.96)

Wall mounted coat hook. Wooden door with glazed panels opens into the entrance hall.

ENTRANCE HALL 15'11" x 5'1" (4.87 x 1.57)

Staircase rising to the first floor landing & lower ground floor. Doors opening into bedrooms 3 & 4.

BEDROOM THREE 12'8" x 10'10" max (3.87 x 3.32 max)

uPVC double-glazed bay window to the front.

BEDROOM FOUR 9'4" x 8'4" (2.86 x 2.55)

uPVC double-glazed window overlooking the rear garden.

FIRST FLOOR LANDING

Doors leading off to bedrooms 1 & 2. Exposed wooden floor boards. Fitted shelving. Wall mounted Ideal Logic combination boiler to the rear wall. Access hatch to roof void.

BEDROOM ONE 11'9" x 8'10" (3.59 x 2.71)

2 uPVC double-glazed windows to the front. Exposed wooden floor boards. Sliding doors opens to the en-suite.

EN-SUITE 9'1" x 2'5" (2.77 x 0.75)

Matching suite of close coupled wc, wash hand basin inset into vanity storage cupboards below & shower cubical with dual shower heads both rainfall & handheld. Ceiling spotlights. Tiled-effect vinyl flooring.

BEDROOM TWO 9'3" x 9'1" (2.84 x 2.77)

uPVC double-glazed window to the rear. Door to a storage cupboard.

LOWER GROUND FLOOR

The room opens into the kitchen.

KITCHEN 14'0" x 9'4" (4.27 x 2.85)

Attractive white high gloss matching base & wall mounted units to include fitted oven & space for an upright fridge/freezer & washing machine. Square edge wood worktops with inset 1.5 bowl white ceramic sink unit, with mixer tap & a 4 ring ceramic hob with filter hood over. Tiled splash-back. uPVC double-glazed window to the rear. Door to a larder storage cupboard. Tiled effect vinyl flooring. Doorway opening into the lounge.

LOUNGE 13'11" x 11'11" (4.25 x 3.65)

Feature fireplace with wooden mantle & surround, cast iron inset with decorative tiles & living flame gas fire with tiled hearth. uPVC double-glazed bay window to the front.

INNER HALLWAY 4'0" x 3'1" (1.23 x 0.94)

uPVC obscured double-glazed door which opens to the rear garden. Door into the bathroom.

BATHROOM 9'1" x 5'10" (2.79 x 1.78)

Attractive matching suite of panelled bath, separate shower cubical with dual shower heads both rainfall & handheld, close coupled wc & wash hand basin inset into vanity storage cupboards below. Heated towel rail. Obscured uPVC double-glazed window to the side. Ceiling spotlights. Extractor fan.

OUTSIDE

To the rear we have an enclosed courtyard garden which consists of a concrete seating area with a couple of steps leading up to a raised deck which provides a nice space to entertain family & friends in. Boundaries are a stone wall with wood trellis to one side. A wooden gate gives access out to the side lane.

COUNCIL TAX

Plymouth City Council  
Council Tax Band: B

SERVICES PLYMOUTH

The property is connected to all the mains services: gas, electricity, water and drainage.

Area Map



Floor Plans

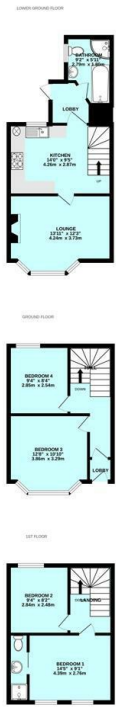

Made with Metagis C2025

Energy Efficiency Graph

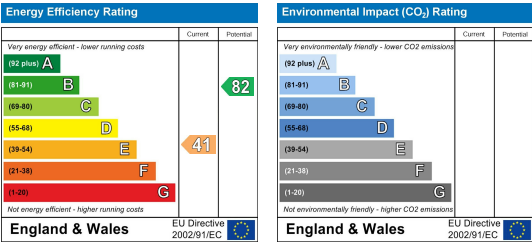

These particulars, whilst believed to be accurate are set out as a general outline only for guidance and do not constitute any part of an offer or contract. Intending purchasers should not rely on them as statements of representation of fact, but must satisfy themselves by inspection or otherwise as to their accuracy. No person in this firms employment has the authority to make or give any representation or warranty in respect of the property.